

STEP Conveyor Flat Top 1000x1500mm H320-400

This modular conveyor segments/belt are made of Acetal material and are easier to wash, as well as more resistant to sharp and abrasive materials. This is well-suited to applications that involve travelling around corners. In fact, they can travel straight, go around a corner, and incline and decline using a single belt and the same motor all throughout. Easy to Clean and spacing between plastic segments are adjustable.

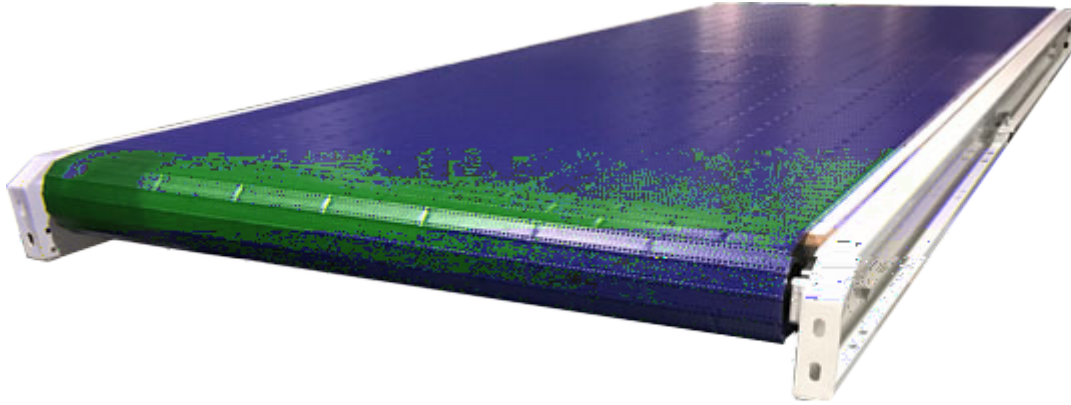

Applications:



Specifications	
Product Name	STEP Conveyor Flat Top 1000x1500mm H320-400mm
Width	1000mm
Length	1500mm
Height	320-400mm adjustable
Belt Material	Acetal FDA approved
Temperature	-40 to 80C
Electrical Connection	To be specified per agreed on project
Item No.	47211000-1500

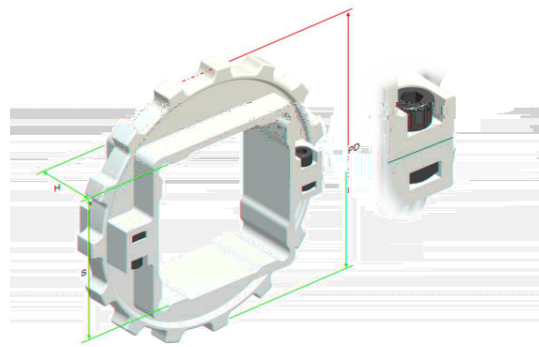
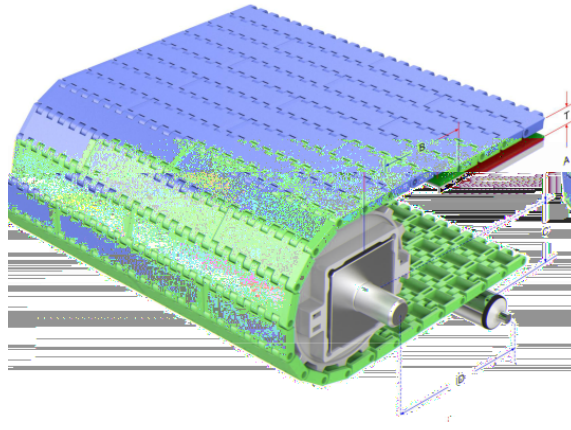

Sprocket Dimensions			Unit: mm		
No. Teeth	PD	S	D	H	K
10	80	--	25.2	25	8X8
12	96.7	38.5/40.5	25.4/38.1	25	8X8
12-Split	96.7	38.5/40.5	38.1	25	9.52X4.76
15	121.3	38.2/40.2/50.2/60.2/63.5	35.5/50.2	29.5	8*8
15-Split	121.3	38.5/40.5/50.5/60.5/63.5/65.5	--	33	--
18	146	38.5/40.5/45.5/50.5/60.5	25.4/50.2	25	14X4
18-Split	146	38.5/60.5	50.8	35	14X5
19-Split	154.5	38.5/40.5/50.5/60.5/65.5	--	35	--
24-Split	194	60.5/65.5			